

NOTES:

1. MATERIAL:
  - 1.1 HOUSING: THERMOPLASTIC, HIGH TEMP.UL94V-0; COLOR:WHITE.
  - 1.2 ACTUATOR: THERMOPLASTIC, HIGH TEMP.UL94-0; COLOR:BLACK.
  - 1.3 CONTACT: COPPER ALLOY
  - 1.4 SHELL: COPPER ALLOY
2. FINISH:
  - 2.1 CONTACT:
    - 50u" MIN. NICKEL PLATING OVERALL
  - 2.2 SHELL:
    - 50u" MIN. NICKEL PLATING OVERALL
    - 40u" MIN. MATT TIN PLATING ON CONTACT&SOLDER
3. SPEC. PLS. REFER TO PS-51695-XXXXX-XXX
4. PACKAGE PLS. REFER TO 51695-XXXXX-XX-TRP
5. PART NUMBER

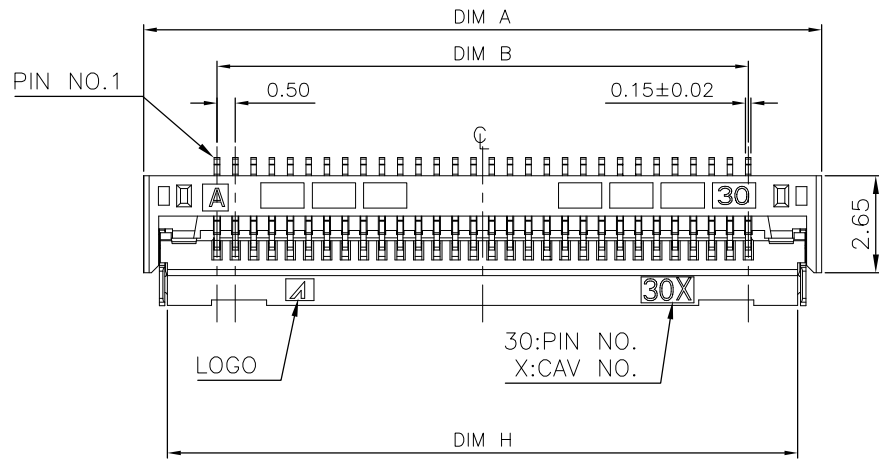

52526-XXX X X-XXX  
 NO OF CKT \_\_\_\_\_ PLATING: 001: NONE  
 PACKING: \_\_\_\_\_ 1:GOLD FLASH PLATING ON CONTACT AND  
 0: TAPE & REEL 0: TAPE & REEL SOLDER FOR SELECTIVENESS PLATING

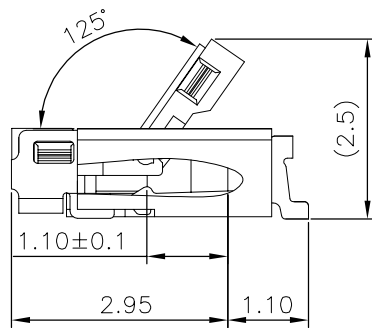
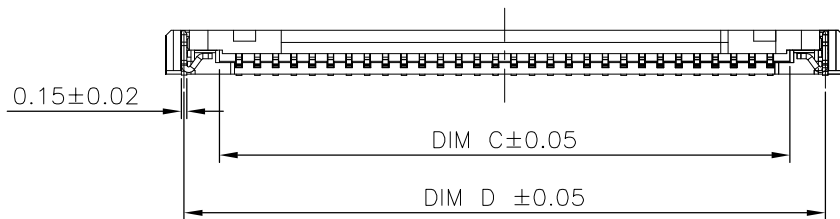
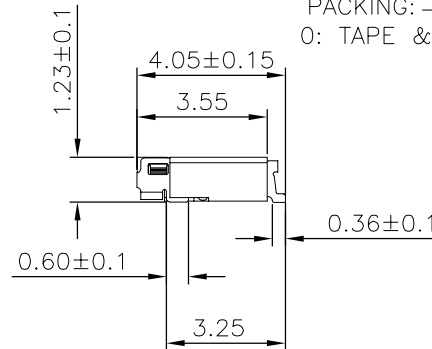

SCALE 2.5:1

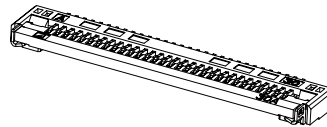

| CKT | DIM A | DIM B | DIM C | DIM D | DIM E | DIM F | DIM G | DIM H |
|-----|-------|-------|-------|-------|-------|-------|-------|-------|
| 14  | 10.50 | 6.50  | 7.57  | 9.50  | 7.50  | 9.10  | 7.70  | 9.20  |
| 30  | 18.50 | 14.50 | 15.57 | 17.50 | 15.50 | 17.10 | 15.70 | 17.20 |
| 40  | 23.50 | 19.50 | 20.57 | 22.50 | 20.50 | 22.10 | 20.70 | 22.20 |
| 45  | 26.00 | 22.00 | 23.07 | 25.00 | 23.00 | 24.60 | 23.20 | 24.70 |
| 50  | 28.50 | 24.50 | 25.57 | 27.50 | 25.50 | 27.10 | 25.70 | 27.20 |

|  |   |                   |   |
|--|---|-------------------|---|
| QUALITY SYMBOLS<br>MAJOR Ⓜ<br>CRITICAL Ⓢ | DRAWN BY<br>Wang, Kai Hung                                  | DATE<br>'20/05/28 |   |
|  | CHECKED BY<br>Liu, Yuan Huang                               | DATE<br>'20/05/28 |   |
| GENERAL TOLERANCES<br>(UNLESS SPECIFIED) | APPROVED BY<br>Wang, Chun Sheng                             | DATE<br>'20/05/28 | TITLE<br>0.5 MM PITCH EASY ON FPC<br>CONN. SMT R/A B/C TYPE |
|  | X. ±0.5<br>.X ±0.25<br>.XX ±0.15<br>.XXX ±0.1<br>ANGLES ±2° | UNITS<br>mm       | SCALE<br>1:1  |
|  | SHEET NO.<br>1 OF 2   | REV<br>A          | DWG NO.<br>52526-XXXXX-XXX                                  |
|  |   |                   | PART NO.<br>SEE NOTES                                       |

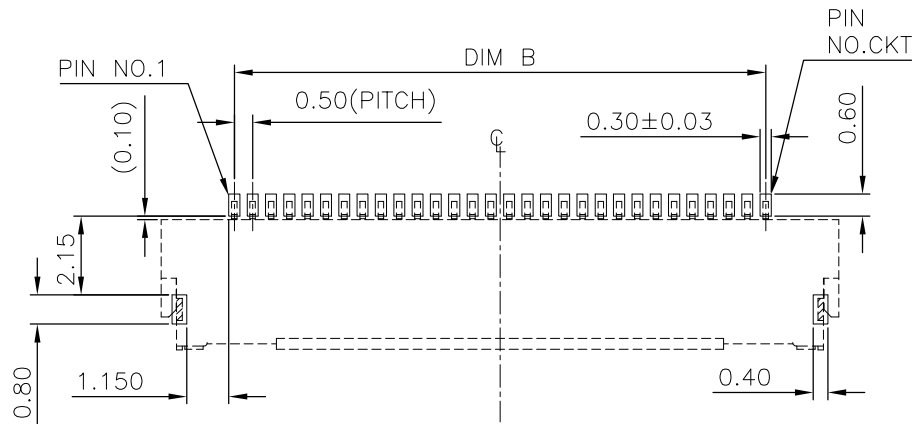

RECOMMENDED PCB LAYOUT  
 GENERAL TOLERANCE  $\pm 0.05$   
 (RECOMMENDED STENCIL THICKNESS=0.12mm)

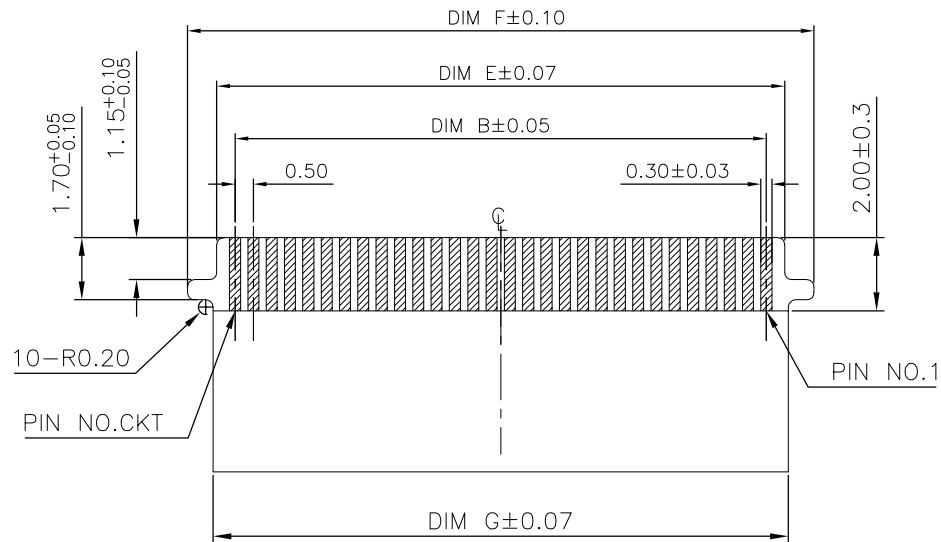

RECOMMENDED FPC/FFC DIMENSIONS  
 GENERAL TOLERANCE  $\pm 0.03$   
 (THICKNESS:0.3±0.03)

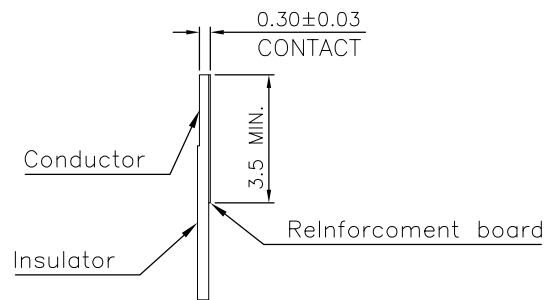

|   |                                 |                     |   |                            |
|---|---------------------------------|---------------------|---|----------------------------|
| QUALITY SYMBOLS<br>MAJOR<br>CRITICAL  | DRAWN BY<br>Wang, Kai Hung      | DATE<br>'20/05/28   |   |                            |
|   | CHECKED BY<br>Liu, Yuan Huang   | DATE<br>'20/05/28   |   |                            |
| GENERAL TOLERANCES<br>(UNLESS SPECIFIED)<br>X. $\pm 0.5$<br>.X $\pm 0.25$<br>.XX $\pm 0.15$<br>.XXX $\pm 0.1$<br>ANGLES $\pm 2^\circ$ | APPROVED BY<br>Wang, Chun Sheng | DATE<br>'20/05/28   | TITLE<br>0.5 MM PITCH EASY ON FPC<br>CONN. SMT R/A B/C TYPE |                            |
|   | UNITS<br>mm                     |                     | SIZE<br>A4  | DWG NO.<br>52526-XXXXX-XXX |
|   | SCALE<br>1:1                    | SHEET NO.<br>2 OF 2 | REV<br>A  | PART NO.<br>SEE NOTES      |